

PHILIPS

SW3700



© & ™ Lucasfilm Ltd.
© Disney



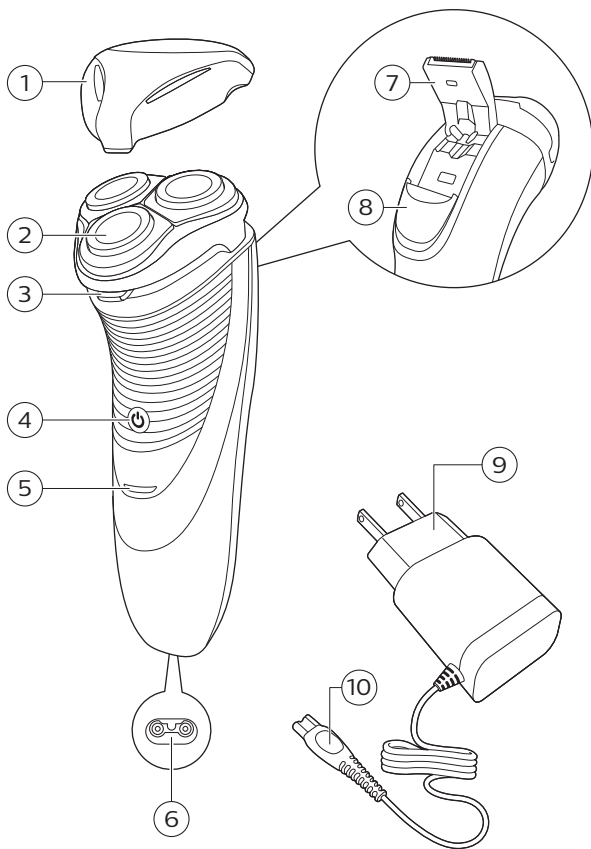

English 6

简体中文 **19**

Introduction

Congratulations on your purchase and welcome to Philips! To fully benefit from the support that Philips offers, register your product at www.philips.com/welcome.

Please read this user manual, as it contains information about the features of this shaver as well as some tips to make shaving easier and more enjoyable.

General description (Fig. 1)

- 1 Protective cap
- 2 Shaving unit
- 3 Shaving unit release button
- 4 On/off button
- 5 Charging light
- 6 Socket for small plug
- 7 Trimmer
- 8 Trimmer release slide switch
- 9 Supply unit
- 10 Small plug

Important safety information

Read this important information carefully before you use the appliance and its accessories and save it for future reference. The accessories supplied may vary for different products.

Danger



- Keep the supply unit dry.

Warning

- To charge the battery, only use the detachable supply unit (HQ850) provided with the appliance.
- The supply unit contains a transformer. Do not cut off the supply unit to replace it with another plug, as this causes a hazardous situation.
- This appliance can be used by children aged from 8 years and above and persons with reduced physical, sensory or mental capabilities or lack of experience and knowledge if they have been given supervision or instruction concerning use of the appliance in a safe way and understand the hazards involved. Children shall not play with the appliance. Cleaning and user maintenance shall not be made by children without supervision.
- Always unplug the shaver before you clean it under the tap.
- Always check the appliance before you use it. Do not use the appliance if it is damaged, as this may cause injury. Always replace a damaged part with one of the original type.
- Do not open the appliance to replace the rechargeable battery.

Caution



- Never immerse the cleaning system or the charging stand in water and do not rinse it under the tap.
- Never immerse the shaver in water. Do not use the shaver in the bath or in the shower.
- Never use water hotter than 60°C to rinse the shaver.
- Only use this appliance for its intended purpose as shown in the user manual.
- For hygienic reasons, the appliance should only be used by one person.

8 English

- Never use compressed air, scouring pads, abrasive cleaning agents or aggressive liquids such as petrol or acetone to clean the appliance.
- If your shaver comes with a cleaning system, always use the original Philips cleaning fluid (cartridge or bottle, depending on the type of cleaning system).
- Always place the cleaning system on a stable, level and horizontal surface to prevent leakage.
- If your cleaning system uses a cleaning cartridge, always make sure the cartridge compartment is closed before you use the cleaning system to clean or charge the shaver.
- When the cleaning system is ready for use, do not move it to prevent leakage of cleaning fluid.
- Water may drip from the socket at the bottom of the shaver when you rinse it. This is normal and not dangerous because all electronics are enclosed in a sealed power unit inside the shaver.
- Do not use the supply unit in or near wall sockets that contain an electric air freshener to prevent irreparable damage to the supply unit.

Electromagnetic fields (EMF)

- This Philips appliance complies with all applicable standards and regulations regarding exposure to electromagnetic fields.

General



- This shaver can be safely cleaned under the tap.
- The supply unit is suitable for mains voltages ranging from 100 to 240 volts.
- The supply unit transforms 100-240 volts to a safe low voltage of less than 24 volts.

Charging

Charge the shaver before you use it for the first time and when the display indicates that the battery is almost empty.

Charging takes approx. 8 hours. A fully charged shaver has a shaving time of up to 40 minutes.

Note: You cannot use the shaver while it is charging.

Note: Depending on your shaving/styling behavior and beard type, the operating time may vary over time.

Charging with the supply unit

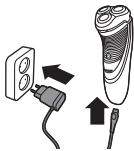

- 1 Make sure the shaver is switched off.
- 2 Put the small plug in the shaver and put the supply unit in the wall socket.
 - The charging light on the shaver indicates the charging status (see 'Charge indications').
- 3 After charging, remove the supply unit from the wall socket and pull the small plug out of the shaver.

Charge indications

Battery low

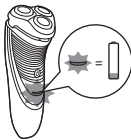

When the battery is almost empty, the charging light starts to flash red.

When you switch off the shaver, the charging light continues to flash red for a few seconds.

Charging

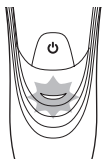

When the shaver is charging, the charging light flashes green.

Battery fully charged

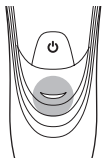

When the battery is fully charged, the charging light lights up green continuously.

Note: After approx. 30 minutes, the charging light goes out to save energy.

Using the shaver

Always check the shaver and all accessories before using. Do not use the shaver or any accessory if it is damaged, as this may cause injury. Always replace a damaged part with one of the original type.

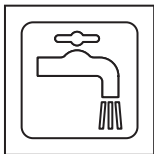

This symbol indicates that the product can be rinsed under running tap water.

- Use this shaver for its intended household use as described in this manual.
- For hygienic reasons, the shaver should only be used by one person.
- Trimming is easier when the skin and hair are dry.

Note: This shaver can only be used without a cord.

Skin adaptation period

Your first shaves may not bring you the result you expect and your skin may even become slightly irritated. This is normal. Your skin and beard need

time to adapt to any new shaving system. To allow your skin to adapt to this new appliance, we advise you to shave regularly (at least 3 times a week) and exclusively with this appliance for a period of 3 weeks.

For the best results on skin comfort, pre-trim your beard if you have not shaved for 3 days or longer.

Start-up sequence

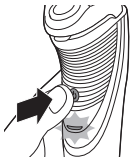

When you press the on/off button for the very first time, the charging light flashes in an irregular pattern.

Charge the shaver before use.

Switching the shaver on and off

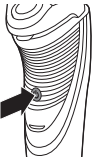

- 1 To switch the shaver on or off, press the on/off button once.

Dry shaving



- 1 Switch the shaver on.
- 2 Move the shaving heads over your skin in both straight and circular movements to catch all hairs growing in different directions. Exert gentle pressure for a close comfortable shave.

Note: Do not press too hard, this can cause skin irritation.

- 3 Switch off and clean the shaver after each use.
- 4 Put the protective cap on the shaver to protect shaving heads.

Using the trimmer

You can use the trimmer to groom your sideburns and moustache.



- 1 Push the trimmer release slide switch downwards to open the trimmer.
- 2 Switch the shaver on.



- 3 Hold the trimmer perpendicular to the skin and move it downwards while exerting gentle pressure.
- 4 Switch off and clean the trimmer after each use.

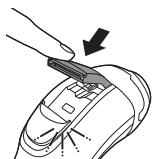

- 5 Close the trimmer ('click').

Cleaning and maintenance

- Regular cleaning guarantees better shaving results.
- Never clean, remove or replace the shaving unit while the shaver is switched on.
- Do not apply pressure to shaving head combs.
- Do not touch shaving heads with hard objects as this may dent or damage the precision-made slotted combs.
- Do not use abrasives, scourers or aggressive liquids such as gasoline or acetone to clean the shaver.

Cleaning the shaver under the tap

Clean the shaver after every shave for optimal shaving performance.

Always check if the water is too hot, to prevent burning your hands.

Never dry the shaving unit with a towel or tissue, as this may damage the shaving heads.

While rinsing shaving heads, water may drip out of the base of shaver. This is a normal occurrence.

- 1 Switch the shaver off.
- 2 Rinse the shaving unit under a warm tap.
- 3 Press the unit release button to open the shaving unit.
- 4 Rinse the shaving unit and hair chamber under a warm tap.
- 5 Carefully shake off excess water and let the shaver air dry.
- 6 Close the shaving unit.

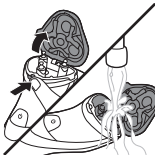

Cleaning the trimmer

Never dry the trimmer with a towel or tissue, as this may damage the trimming teeth.

Clean the trimmer after each use.

- 1 Switch the shaver off.

14 English



- 2 Push the trimmer release slide switch down to open the trimmer.



- 3 Switch the shaver on and rinse the trimmer under the tap.
- 4 Switch the shaver off after cleaning.
- 5 Carefully shake off excess water and let the trimmer air dry.
- 6 Close the trimmer ('click').



Tip: For optimal performance, lubricate the teeth of the attachment with a drop of sewing machine oil regularly.

Replacement

Replacing the shaving heads



For maximum shaving performance, we advise you to replace the shaving heads every two years. Replace damaged shaving heads immediately. Always replace the shaving heads with original Philips shaving heads.

- 1 Switch the shaver off and disconnect it from the wall socket.
- 2 Press the shaving unit release button to open the shaving unit. Pull the shaving unit off the shaver.

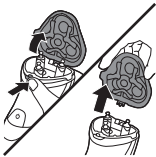

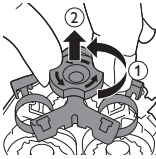

- 3** Turn the lock anticlockwise and remove the retaining frame. Place it aside in a safe place.

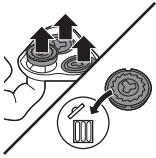

- 4** Remove the shaving heads from the shaving unit.

Discard the used shaving heads immediately to avoid mixing them with the new shaving heads.

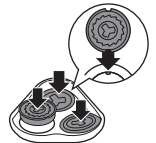

- 5** Place new shaving heads in the shaving unit.

Note: Make sure the notches on both sides of the shaving heads fit exactly onto the projections in the shaving head holder.

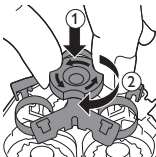

- 6** Put the retaining frame back into the shaving unit and turn the lock clockwise.

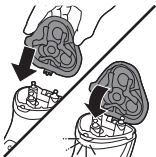

- 7** Insert the lug of the shaving unit into the slot in the top of the shaver. Then close the shaving unit.

Note: If the shaving unit does not close smoothly, check if you have inserted the shaving heads properly and if the retaining frame is locked.

Storage



Put the protective cap on the shaver to prevent damage.

Note: Always let the shaver dry completely before storing.

Ordering accessories

To buy accessories or spare parts, visit **www.shop.philips.com/service** or go to your Philips dealer. You can also contact the Philips Consumer Care Center in your country (see the international warranty leaflet for contact details).

The following accessories and spare parts are available:

- SH30 Philips Shaving Heads.
- HQ110 Philips shaving head cleaning spray

Recycling

- Do not throw away the product with the normal household waste at the end of its life, but hand it in at an official collection point for recycling. By doing this, you help to preserve the environment.
- This product contains a built-in rechargeable battery which shall not be disposed of with normal household waste. We strongly advise you to take your product to an official collection point or a Philips service centre to have a professional remove the rechargeable battery.
- Follow your country's rules for the separate collection of electrical and electronic products and rechargeable batteries. Correct disposal helps prevent negative consequences for the environment and human health.

Removing the rechargeable battery

Only remove the rechargeable battery when you discard the shaver. Before you remove the battery, make sure that the shaver is disconnected from the wall socket and that the battery is completely empty

Take any necessary safety precautions when you handle tools to open the shaver and when you dispose of the rechargeable battery.

- 1 Check if there are screws in the back of the shaver or in the hair chamber. If so, remove them.
- 2 Remove the outer panels of the shaver with a screwdriver or other tool. If necessary, also remove additional screws and/or parts until you see the printed circuit board with the rechargeable battery.
- 3 Remove the rechargeable battery.

Warranty and support

If you need information or support, please visit **www.philips.com/support** or read the international warranty leaflet.

Warranty restrictions

The shaving heads (cutters and guards) are not covered by the terms of the international warranty because they are subject to wear.

Troubleshooting

This chapter summarizes the most common problems you could encounter with the appliance. If you are unable to solve the problem with the information below, visit **www.philips.com/support**

18 English

for a list of frequently asked questions or contact the Consumer Care Center in your country.

Problem	Possible cause	Solution
The appliance does not shave as well as it used to.	The shaving heads are damaged or worn.	Replace the shaving heads.
	Long hairs obstruct the shaving heads.	Clean the shaving heads one by one.
The appliance does not work when I press the on/off button.	You have not inserted the shaving heads properly.	Make sure that the projections of the shaving heads fit exactly into the recesses.
	The rechargeable battery is empty.	Recharge the battery.
	The temperature of the appliance is too high. In this case, the appliance does not work.	As soon as the temperature of the appliance has dropped sufficiently, you can switch on the appliance again.

介绍

感谢您的惠顾，欢迎光临飞利浦！为了让您能充分享受飞利浦提供的支持，请在 www.philips.com/welcome 上注册您的产品。

请阅读本用户手册，手册包含有关此剃须刀各种功能的信息以及一些使用技巧，让您的剃须体验更轻松更舒适。

基本说明（图 1）

- 1 保护盖
- 2 剃须刀头部件
- 3 剃须刀头部件释放按钮
- 4 开/关按钮
- 5 充电指示灯
- 6 小插头插口
- 7 修剪器
- 8 修剪器滑动释放开关
- 9 电源部件
- 10 小插头

重要安全信息

使用本产品及其附件之前，请仔细阅读本重要信息，并妥善保管以供日后参考。随附的附件可能因产品而异。

危险



- 保持电源部件干燥。
- 警告符号注释：禁止在打开的水龙头下进行清洗。

警告

- 要给电池充电，请仅使用产品随附的可拆卸电源部件 (HQ850)。

- 电源部件中包含一个变压器。请勿自行更换电源部件的插头，否则将导致严重后果。
- 本产品也可以由 8 岁或以上年龄的儿童以及肢体不健全、感觉或精神上有障碍或缺乏相关经验和知识的人士使用，但前提是有人对他们使用本产品进行监督或指导，以确保他们安全使用，并且让他们明白相关的危害。切勿让儿童玩弄本产品。不要让儿童在无人监督的情况下对本产品进行清洁和保养。
- 将剃须刀手持部分与电源软线分开后，才能在水龙头下清洗手持部分。
- 使用前，请务必检查产品。请勿使用损坏的产品，否则可能对人体造成伤害。请务必用原装型号更换损坏的部件。
- 切勿拆开本产品更换充电电池。

警告



- 切勿将清洁系统或充电座浸入水中，也不要在水龙头下冲洗。
- 切勿将剃须刀浸入水中。切勿在洗澡或淋浴时使用剃须刀。
- 切勿使用温度高于 60°C 的热水冲洗剃须刀。
- 只能将本产品用于用户手册中所示的原定用途。
- 出于卫生的目的，本产品只能供一个人使用。
- 切勿使用压缩气体、钢丝绒、研磨性清洁剂或腐蚀性液体（例如汽油或丙酮）来清洁产品。
- 如果剃须刀随附清洁系统，应始终使用原装飞利浦清洁液（滤芯或瓶，取决于清洁系统类型）。
- 清洁系统必须放在稳定、平坦的水平表面上，以防漏液。
- 如果清洁系统采用清洁滤芯，在使用清洁系统进行清洁或为剃须刀充电之前，应始终确保滤芯仓已关闭。
- 清洁系统准备就绪时，切勿移动，以免清洁液漏出。
- 冲洗剃须刀时，水可能从产品底部的插口漏出。这是正常的，而且没有危险，因为所有电子元件都封闭在剃须刀内部的密封电源部件中。

- 请勿在包含电动空气清新器的墙壁插座上或其周围使用电源部件，以免电源部件受到不可修复的损坏。

电磁场 (EMF)

- 本 Philips 产品符合所有有关暴露于电磁场的适用标准和法规。

概述



- 这款剃须刀可放心在水龙头下清洗。
- 符号注释：适合用在打开的水龙头下进行清洗。
- 电源部件适合在 100 - 240 伏的电源电压下工作。
- 该电源部件可将 100-240 伏的电压转换为 24 伏以下的安全低电压。

充电

首次使用剃须刀之前，或当显示屏指示电池电量几乎耗尽时，请先为剃须刀充电。

充电约需 8 小时。充满电的剃须刀最长剃须时间可达 40 分钟。

注意：切勿在充电时使用剃须刀。

注意：剃须刀的使用时间可能因您的剃须/造型方式和胡须类型而异。

使用电源部件充电

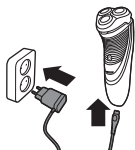

- 1 确保剃须刀已关闭。
- 2 将小插头插入剃须刀，然后将电源部件插入电源插座。
 - 剃须刀上的充电指示灯显示充电状态 (请参见 '充电指示')。
- 3 充电之后，从电源插座上拔下电源部件，并从剃须刀上拔下小插头。

充电指示

电池电量不足

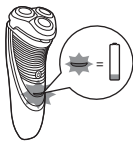

电池电量即将用时，充电指示灯会呈红色闪烁。
关闭剃须刀时，充电指示灯将呈红色继续闪烁几秒钟。

充电

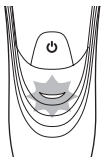

剃须刀在充电时，充电指示灯闪烁绿色。

电池已完全充满

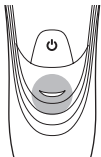

电池充满电时，充电指示灯将持续亮起绿灯。

注意： 大约 30 分钟后，充电指示灯熄灭以节省能源。

使用剃须刀

使用前务必要检查剃须刀和所有配件。如果剃须刀或任何配件损坏，请勿再使用，否则可能对人体造成伤害。请务必用原装型号更换损坏的部件。

符号注释：适合用在打开的水龙头下进行清洗。

- 请按照本用户手册中所述的预期家用用途使用本剃须刀。
- 出于卫生考虑，请勿共用剃须刀。
- 皮肤和毛发干燥时修剪更容易。

注意： 本剃须刀只能在不接电源的情况下使用。

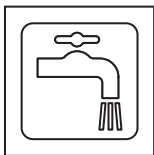

皮肤适应期

前几次剃须可能不会带给您预期效果，并且您的皮肤可能会受到轻度刺激。这是正常的。您的皮肤和胡须需要时间适应任何新的剃须系统。为了让您的皮肤适应这款新产品，我们建议您在 3 周时间内定期（至少每周 3 次）仅使用本产品剃须。

如果您连续 3 天或更长时间没有剃须，为确保皮肤获得最佳舒适感，请预先修剪胡须。

启动顺序

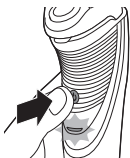

第一次按下开/关按钮时，充电指示灯会不规则闪烁。使用前先为剃须刀充电。

打开或关闭剃须刀

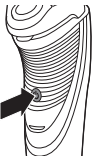

- 1 要打开或关闭剃须刀，请按一下开/关按钮。

干剃



- 1 打开剃须刀。
- 2 让剃须刀头在您的皮肤上作直线和迂回运动，以刮剃向不同方向生长的所有须发。轻轻按压，以获取舒适贴面的剃须感受。

注意： 不要用力按压剃须刀，这样做可能会导致皮肤受刺激。

- 3 每次使用后，请关闭并清洗剃须刀。
- 4 盖上剃须刀保护盖，以保护剃须刀头。

使用修剪器



您可使用修剪器修剪鬓角和须髥。

- 1 向下推修剪器的滑动释放开关可打开修剪器。
- 2 打开剃须刀。



- 3 将修剪器垂直放在皮肤上，向下移动产品，同时轻轻按压。
- 4 每次使用后，请关闭电源并清洁修剪器。

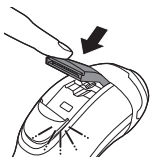

- 5 关闭修剪器（可听到“咔哒”一声）。

清洁和保养

- 为保证更好的剃须效果，请定期清洗剃须刀。
- 切勿在剃须刀开启时清洗、拆除或更换剃须刀头部件。
- 请勿对剃须刀头梳齿施加压力。
- 请勿使用硬物触碰剃须刀头，以免挫伤或损坏制作精密的带槽梳齿。
- 切勿使用研磨剂、硬毛刷或汽油或丙酮等腐蚀性液体清洗本剃须刀。

在水龙头下冲洗剃须刀

每次剃须后清洁剃须刀，以维持最佳剃须性能。

切记先检查水温是否太高，以防烫手。

不要用毛巾或纸巾擦拭剃须刀头部件，因为这样可能会损坏剃须刀头。

冲洗剃须刀头时，水可能会从剃须刀底座中滴出。这属于正常现象。

- 1 关闭剃须刀。
- 2 在温水水龙头下冲洗剃须刀头部件。
- 3 按下部件释放按钮，打开剃须刀头部件。
- 4 在热水龙头下冲洗剃须刀头部件和胡茬储藏室。

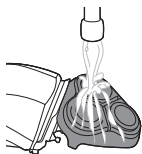

- 5 小心甩干多余的水，然后将剃须刀晾干。
- 6 关闭剃须刀头部件。

清洗修剪器

切勿用毛巾或纸巾擦干修剪器，否则可能会损坏修剪齿。

每次使用后都应清洁修剪器。

- 1 关闭剃须刀。
- 2 向下推修剪器的滑动释放开关可打开修剪器。





- 3 启动剃须刀，并在水龙头下冲洗修剪器。
- 4 清洗完成后，关闭剃须刀。
- 5 小心地甩干多余的水，然后将修剪器晾干。
- 6 关闭修剪器（可听到“咔哒”一声）。



提示：为达到最佳效果，请定期用一滴缝纫机油润滑附件齿部。

更换

更换剃须刀头



为达到最佳剃须效果，建议每两年更换一次剃须刀头。立即更换损坏的剃须刀头。务必使用原装飞利浦剃须刀头进行更换。

- 1 关闭剃须刀并断开与电源插座的连接。
- 2 按下剃须刀头部件释放按钮，打开剃须刀头部件。将剃须刀头部件拉出剃须刀。

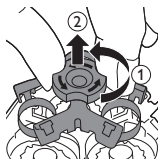
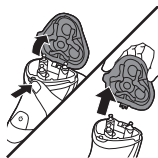

- 3 逆时针方向转动锁装置并卸下固定架。将其存放在安全的地方。

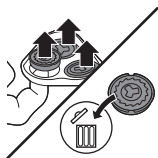

- 4 从剃须刀头部件中取下剃须刀头。

直接丢弃用过的剃须刀头，以免与新的剃须刀头混淆。

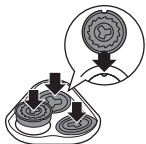

- 5 将新的剃须刀头放在剃须刀头部件中。

注意：确保剃须刀头两侧的槽口正好卡入剃须刀头支架上的凸起部位。

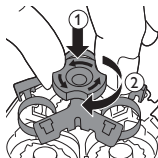

- 6 将固定架放回剃须刀头部件内，并沿顺时针方向转动锁装置。

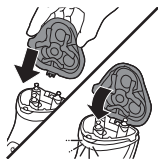

- 7 将剃须刀头部件的凸缘插入剃须刀顶部的槽内。然后关闭剃须刀头部件。

注意：如果剃须刀头部件关闭不畅，请检查剃须刀头插入是否正确，固定架是否被锁住。

存放



盖上剃须刀保护盖，以防受损。

注意：存放前务必要确保剃须刀彻底干燥。

订购配件

要购买附件或备件，请访问 www.shop.philips.com/service 或联系您的飞利浦经销商。您还可以联系所在国家/地区的飞利浦客户服务中心（请参阅全球保修卡了解详细联系信息）。

可选配以下附件和备件：

- SH30 飞利浦剃须刀头。
- HQ110 飞利浦剃须刀头清洁喷雾剂

回收

- 弃置本产品时，请不要将其与一般生活垃圾放在一起，应将其交给政府指定的回收中心。这样做将有利于环保。
- 此产品包含内置充电电池：请勿将充电电池与一般生活垃圾一起弃置。强烈建议您将自己的产品送到官方收集点或飞利浦服务中心，让专业人士移除充电电池。
- 遵循您的国家/地区有关分类回收电子电气产品和充电电池的规定。正确弃置产品有助于避免对环境和人类健康造成不良后果。

拆下充电电池

仅在丢弃剃须刀时方可拆下充电电池。拆下电池之前，请确保剃须刀与插座断开连接，并且电池电量已耗尽

在您使用工具打开剃须刀时，以及在您丢弃充电电池时，请采取必要的安全保护措施。

- 1 检查剃须刀背面或胡茬储藏室中是否有螺钉。如果有，请将其拆下。
- 2 使用螺丝刀或其他工具拆下剃须刀的外面板。必要时还需要拆下更多的螺丝和/或部件，直到您看见装有充电电池的印刷电路板为止。
- 3 拆下充电电池。

产品中有害物质的名称及含量						
部件名称	有害物质					
	铅 (Pb)	汞 (Hg)	镉 (Cd)	六价铬 (Cr (VI))	多溴联苯 (PBB)	多溴二苯醚 (PBDE)
PCB's 集成电路板	X	○	○	○	○	○
Electrical contact pins 电接触片	X	○	○	○	○	○
Power plug 电源插头	X	○	○	○	○	○

本表格依据SJ/T 11364的规定编制。
 ○: 表示该有害物质在该部件所有均质材料中的含量均在GB/T 26572规定的限量要求以下。
 X: 表示该有害物质至少在该部件的某一均质材料中的含量超出GB/T 26572规定的限量要求。

- 该表格中所显示的“有害物质”在产品正常使用情况下不会对人身和环境产生任何伤害。
- 该表格中所显示的“有害物质”及其存在的部件向消费者和回收处理从业者提供相关物质的存在信息，有助于产品废弃时的妥善处理。

保修和支持

如需信息或支持，请访问 www.philips.com/support 或阅读国际保修卡。

保修条款

由于剃须刀头（刀片和网罩）属于易磨损物品，因此在国际保修条款的涵盖范围之列。

保修与服务

This guarantee card is valid in China.

This guarantee card should be retained by The USER

此保用卡在中国适用，用户请保留此卡。

保修及服务：

此产品是一件设计精良，用高品质元件制造之家用电器，在正常使用及保养下应能发挥其优越性能。在购买日期后二年内，若发生任何因制造工艺或元器件造成之损坏，飞利浦中国维修服务中心将为持证用户提供免费门市维修服务，视情况更换零件或整个产品。

无论在保期中或保期后，只要飞利浦正式行销该产品的任何国家皆可获得维修服务。

若飞利浦在当地无行销该项产品，飞利浦同样提供维修服务，但可能因未储备所需零件，维修时间可能较长，敬请见谅。请联络当地飞利浦经销商，或飞利浦服务部门。

若您需洽询相关资讯，或遇困难事项时，请联络当地飞利浦维修服务中心，或向飞利浦服务热线咨询。

中国顾客服务热线：4008 800 008 (用户需承担本地通话费)。

网址：<http://www.philips.com.cn>

保修条例：

- 在购买日期后二年内，凡经本公司特约维修站人员确认为正常使用情况下，因制造工艺或元器件造成之损坏，您都将获得免费保修服务。
- 此免费服务不包括需时常更换的易耗零配件（吸尘器纸袋，布袋，空气清新机滤网，滤芯，活性碳，咖啡壶过滤网）及附件（如须刀网膜、刀头，咖啡杯，食品加工机杯/刀具等），辅助装置，运输费及维修人员上门服务费。
- 用户请保留此联。
- 维修时请携同此证及发票正本。
- 此证若经涂改即作废。
- 此证须联同发票正本使用方为有效。
- 以下情况将不能获得免费服务

1 使用不当引起的人为损坏，例如接入不适当电源、使用不适当配件、不适当之安装、不依说明书使用、错误使用或疏忽而造成损坏等。因运输及其他意外而造成之损坏。非经本公司认可之维修和改装。其他因不可抗力（如自然灾害、电压异常等）造成的损坏。

2 一般家庭以外使用（如工业、商业用）而造成的损坏。

3 正常使用引起的产品老化、磨损等，但不影响产品的正常使用。

- 此证仅在中国境内有效。
- 保修证作为在规定期限及条件之内进行免费维修的保证，并不限制消费者的法定权利。

网上会员注册与产品注册：

- 1 登陆 <http://www.philips.com.cn/welcome>
- 2 点击“创建新账户”，创建您的飞利浦账号。
- 3 点击“注册产品”，通过产品名称或产品型号查找产品，完成产品注册

Service information

For after-sales and maintenance service, please call service hotline 4008 800 008. Any comments and enquiries during the service, please Contact our Philips Consumer Lifestyle Customer Care Service Office.

Philips(china)Investment Co.,Ltd. Philips
Consumer Lifestyle Philips Innovation
Campus Shanghai NO.1 Building,
NO.10, Lane 888 Tian Lin Road Shanghai,
P. R. C. 200233

Fax: +86 21 5445 2663

服务须知

如需要此产品的售后服务，请拨打服务热线4008 800 008

如在维修服务过程中有任何意见，

欢迎致函飞利浦优质服务办事处解决疑难。

飞利浦（中国）投资有限公司

飞利浦优质服务客户服务部

中国上海市田林路888弄10号

飞利浦创新科技园1号楼

邮政编码：200233 传真：（021）5445 2663

故障种类和处理方法

本章归纳了使用本产品时最常见的一些问题。如果您无法根据以下信息解决问题，请访问 www.philips.com/support 查阅常见问题列表，或联系您所在国家/地区的客户服务中心。

问题	可能的原因	解决方法
产品的剃须效果没有以前好。	剃须刀头已损坏或磨损。	更换剃须刀头。
	较长的胡须堵塞了剃须刀头。	逐一清洁剃须刀头。
	您没有正确插入剃须刀头。	确保剃须刀头凸起部位正好插入凹陷部位。
按下开/关按钮时，产品不工作。	充电电池的电量已耗尽。	给电池充电。
	产品的温度过高。此时，产品无法工作。	一旦产品降到足够低的温度，便可重新打开产品。

PHILIPS

产品 : 飞利浦电动剃须刀
 型号 : SW3700
 额定电压 : 220V~
 额定频率 : 50Hz
 额定输入功率: 2 W
 生产日期 : 请见产品本体
 产地 : 中国广东珠海



珠海经济特区飞利浦家庭电器有限公司
 中国珠海市三灶镇琴石工业区
 全国顾客服务热线: 4008 800 008

本产品根据国标 GB4706.1-2005,
 GB4706.9-2008制造

保留备用

发行日期: 14/8/2017

— |

| —

— |

| —

— |

| —

— |

| —



© 2017 Koninklijke Philips N.V.

All rights reserved

保留所有权利

4222.002.7378.1 (14/8/2017)

> 75% 循环再造纸



>75% recycled paper

>75% papier recyclé